

4.3 Resolver Connection

Resolver connector

motor side

SSD Drives - motor size 0...4

Type: AC G, AC R, AC Mn,
AC M2n, AC M2K; ACM2G
AC MRW, AC MRL

regulator side

SSD Drives - servo drives

Model: 631/635 and 637/637+/637f

view solderside

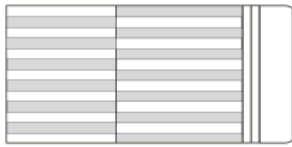

view solderside

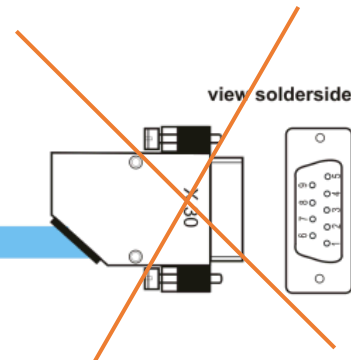

SIR ST.0200.0001	KIR -B KA.0003.6301		SUB - D 09 S/M ST.1002.2001
PIN - Nr.	colour	function	PIN - Nr.
1	white	sin +	4
2	brown	sin -	8
3	green	cos +	3
4	yellow	cos -	7
5	red	PTC optional	2
6	blue	PTC optional	6
7	pink	carrier -	9
8	gray	carrier +	5
case		screen	case

ung reglerseitig

8
7
12
11
5
10
15
4
Gehäuse

Resolver / Feedback (connector)

Resolver 1:1 (meaning)

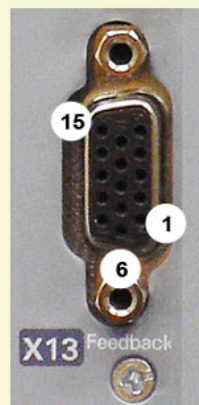

Assignment with feedback F10 (Resolver)

PIN X13	Feedback /X13 High Density /Sub D
	Resolver (F10)
1	factory use
2	factory use
3	GND
4	REF-Resolver+
5	+5V (for temperature sensor)
6	factory use
7	SIN-
8	SIN+
9	factory use
10	Tmot*
11	COS-
12	COS+
13	factory use
14	factory use
15	REF-Resolver-

Power 1:1:

Belegung / Kennzeichnung motorseitig		Aderkennzeichnung	regler / rackseitig
1		schwarz 1	V
3		schwarz 2	U
4		schwarz 3	W
2		gelb/grün	PE
A		rot	Br+
B		blau	Br-

